

STEPPED CLOSE SPACE PUNCHES

M-2: Rc 60/63 • A-2: Rc 60/62 • PM-10V: Rc 61/63

STYLE ST

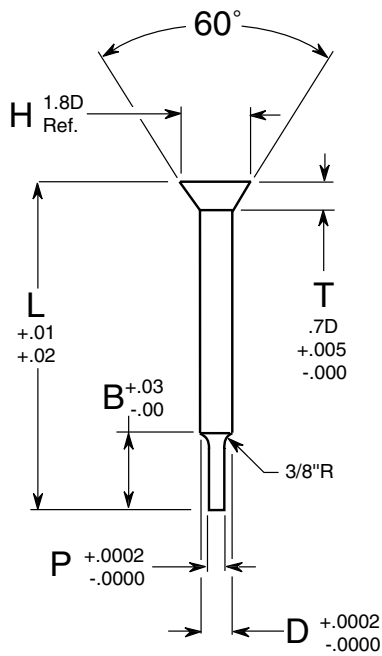

STYLE SA

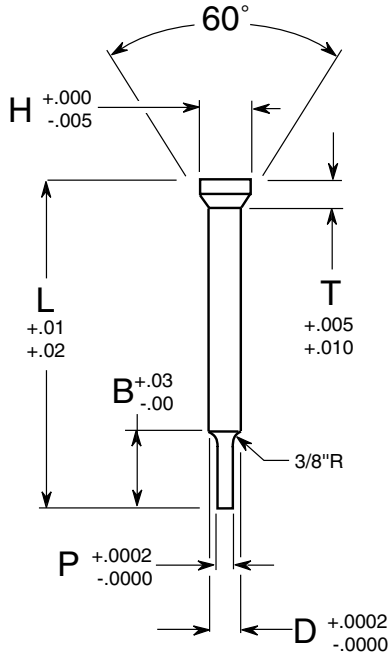

STYLE SB

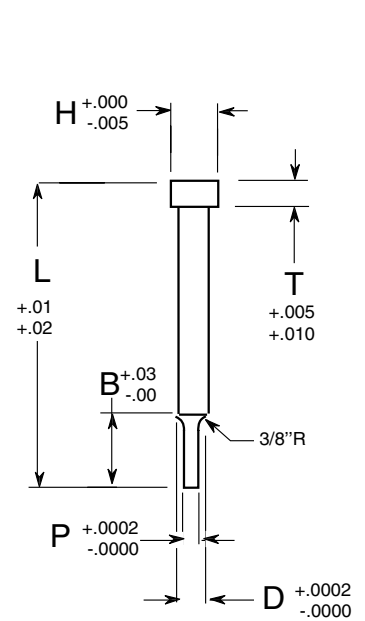

Available on Request	All Styles	D Dia.	L Length	P Point Diameter any .0001 inc.	B Std. Point Length	2 1/2" Price		3" Price**		
						A-2	M-2	PM-10V	A-2	M-2
	-06	.0625	Standard 2 1/2" - 3 1/2" Cut to Length See cut off charge	Min.	.031	3/16	6.06	8.31	6.76	9.56
	-09	.0938		Min.	.062	1/4	6.06	8.31	6.76	9.56
	-12	.125		Min.	.093	5/16	6.31	8.74	7.09	10.10
	-15	.1562		Min.	.125	3/8	6.37	8.81	7.14	10.19
	-18	.1875		Min.	.156	7/16	6.65	9.19	7.43	10.62
	-21	.2188		Min.	.182	1/2	6.93	9.62	7.64	11.16
	-25	.250		Min.	.218	5/16	6.93	9.62	7.64	11.16
	-31	.3125		Min.	.281	3/8	8.04	11.31	8.73	13.30
	-37	.375		Min.	.343	3/8	8.45	12.15	9.07	14.35

Min. Cut-off Charge \$5.00		
Diameter	.0625 - .125	.1562 - .375
Price Each	.30	.40

Quantity Discounts				
1 - 5	6-24	25 - 49	50 - 99	100 +
\$10 Set	Net	5%	10%	Call

How To Order: EXAMPLE				
Style	Length	Mat.	Pt. Dia.	Qty.
SB 06	2"	A-2	.031	15

- Delivery: 1 - 3 days
- (*) SB only

• **See page 4 for Blank sizes available