

M-2 HIGH SPEED STEEL PERFORATORS

Form Ground • Rc 60/63

D .001 Increments	H	T	L - Price by Length							
			2½"	3"	4"	6"	8"	10"	12"	
.010 - .014	1/32	1/16	2" 3.26)	3.94	5.25	7.09	-	-	-	-
.015 - .019	1/32	1/16	2" 2.68)	3.26	4.52	6.57	-	-	-	-
.020 - .029	3/64	1/16	2" 2.16)	2.63	3.94	5.99	-	-	-	-
.030 - .036	1/16	1/16	1.74	3.63	5.41	-	-	-	-	-
.037 - .046	5/64	1/16		3.63	4.99	9.19	15.12	-	-	-
.047 - .055	3/32	3/32		3.00	4.68	8.82	14.13	-	-	-
.056 - .064	7/64	3/32	1.90	2.44	4.33	7.95	13.91	-	-	-
.065 - .078	1/8	3/32					13.36	-	-	-
.079 - .087	9/64	3/32	2.11	2.66	4.01	7.57	12.83	-	-	-
.088 - .099	5/32	3/32					-	-	-	-
.100 - .120	11/64	3/32	2.26	2.80	4.17	7.80	11.92	16.68	21.46	20.98
.121 - .131	3/16	1/8								
.132 - .147	13/64	1/8	2.58	3.19	4.56	8.18	12.29	17.23	22.17	22.17
.148 - .163	7/32	1/8								
.164 - .179	15/64	1/8	3.07	3.63	5.06	8.80	13.10	18.37	23.66	23.66
.180 - .194	1/4	1/8								
.195 - .210	17/64	1/8	3.41	4.03	5.45	9.59	14.07	19.74	25.35	25.35
.211 - .225	9/32	1/8								
.226 - .241	19/64	1/8	3.70	4.41	5.74	9.93	14.41	20.19	25.98	25.98
.242 - .257	5/16	3/16								
.258 - .272	21/64	3/16	4.49	5.11	6.98	8.23	12.54	17.13	23.99	30.85
.273 - .288	11/32	3/16								
.289 - .304	23/64	3/16	5.74	7.61	8.91	13.16	17.81	24.95	32.10	32.10
.305 - .320	3/8	3/16								
.321 - .336	25/64	3/16	6.44	8.85	10.10	14.58	19.17	26.89	34.54	34.54
.337 - .352	13/32	3/16								
.353 - .368	27/64	3/16	ON REQUEST	ON REQUEST	ON REQUEST	ON REQUEST	ON REQUEST	ON REQUEST	ON REQUEST	ON REQUEST
.369 - .375	7/16	3/16								
.376 - .436	D + .06 + .09	3/16	4.49	5.74	7.03	11.24	15.77	22.12	28.42	28.42
.437 - .484		3/16	5.11	6.98	8.23	12.54	17.13	23.99	30.85	30.85
.485 - .562		3/16	5.74	7.61	8.91	13.16	17.81	24.95	32.10	32.10
.563 - .625		3/16	6.44	8.85	10.10	14.58	19.17	26.89	34.54	34.54
.626 - 1.000		3/16	ON REQUEST	ON REQUEST	ON REQUEST	ON REQUEST	ON REQUEST	ON REQUEST	ON REQUEST	ON REQUEST

STYLE TB

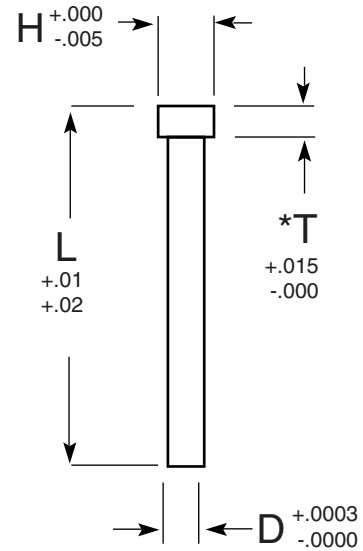

* Optional "T" of 3/16"
All Sizes

Min. Cut-off Charges \$5.00					
Diameter	.010 - .029	.030 - .125	.126 - .375	.376 - .499	.500 - .625
Price Each	on request	.30	.40	.60	on request

Quantity Discounts			
1 - 24	25 - 49	50 - 99	100 +
NET	5%	10%	Call

How To Order: EXAMPLE				
Style	Dia.	Length	Mat.	Qty.
TB	.126	2.50"	M-2	50

- Unshaded sizes in stock
- Larger diameter or optional material on request
- Shaded sizes - any .0001 increment - no charge

- Set-up Charges - shaded sizes only
 - 2 1/2 - 4" = \$25.00
 - 6 - 8" = \$30.00
 - 10 - 12" = \$50.00