

CUSTOM SHAPES

Available on SP* & PE* Punches • DB* & DH* Dies

S1

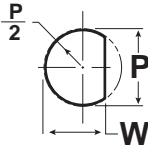

S2

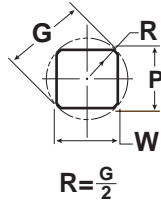

S3

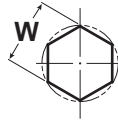

S4

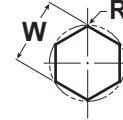

S5

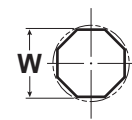

A = Even No. of Sides

S6

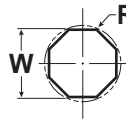

A = Even No. of Sides

S7



A = Odd No. of Sides

S8



A = Odd No. of Sides

S9

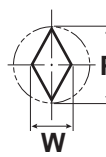

S10

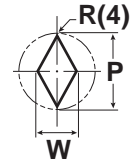

S11



S12

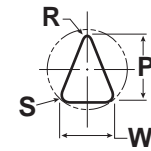

S13

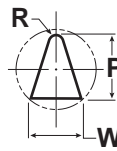

S14



S15

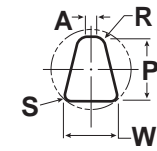

S16

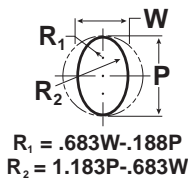

S17

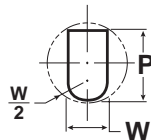

S18

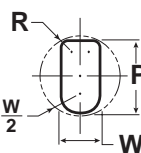

S19

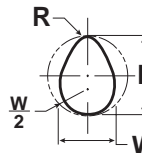

S20

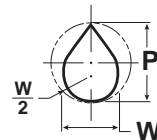

How to Order: EXAMPLES

Style	Length	Mat.	Pt. Dim. PxW R	Pt. Length	Tol.	Keying	Qty.
SP-S18-50	2 1/4"	10-V	.418 x .324 R .007	1	#2	2D	4
DB-S18-62	1"	10-V	.420 x .326 R .008	-	#2	2D	4

Notes Pertaining to the Table:

- Corner Radius – Inside: Punches and Dies – .003 to .008 (Both)
Outside: Punches and Dies – Sharp (Both, unless specified)
- Center line on drawing indicates center line of body diameter