

## NITRIDED EJECTOR PINS

Surface Hardness Rc 64/74 • Core Hardness Rc 35/40 • Shoulder Type

Style No. MP5	D Pin Dia.	Length		
		6"	10"	14"
046	3/64	4.35	5.53	7.09
051	.005 3/64 O.S.	-	6.10	-
062	1/16	4.13	5.17	6.67
067	.005 1/16 O.S.	-	5.76	-
078	5/64	4.13	5.17	6.76
083	.005 5/64 O.S.	-	5.76	11.50
093	3/32	3.69	4.69	6.41
098	.005 3/32 O.S.	-	5.28	11.40
109	7/64	3.69	4.69	6.41
114	.005 7/64 O.S.	-	5.28	11.35

### STYLE MP5

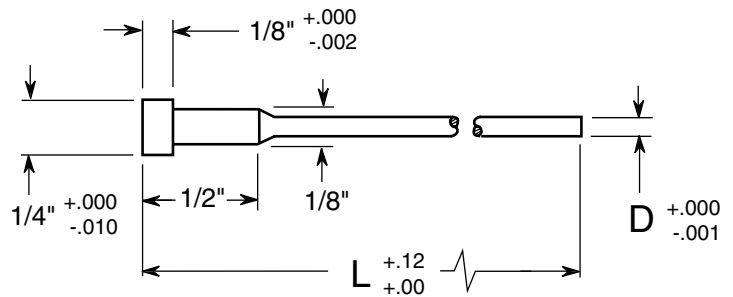

Style No. MP20	D Pin Dia.	Length		
		6"	10"	14"
046	3/64	4.24	4.89	6.87
051	.005 3/64 O.S.	-	5.88	-
062	1/16	4.08	4.93	6.30
067	.005 1/16 O.S.	-	5.53	-
078	5/64	4.08	4.93	6.43
083	.005 5/64 O.S.	-	5.53	11.50
093	3/32	3.53	4.44	6.15
098	.005 3/32 O.S.	-	5.04	11.40
109	7/64	3.53	4.44	6.02
114	.005 7/64 O.S.	-	5.04	11.35

### STYLE MP20

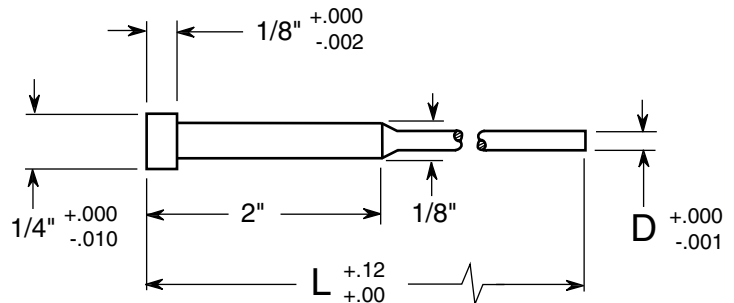

#### How To Order: EXAMPLE

Style	Dia. x Lgth.	Qty.
MP5 046	3/64 x 10"	50