

# NITRIDED EJECTOR PINS

Surface Hardness Rc 64/74 • Core Hardness Rc 35/40

## STYLES NEP & NEO

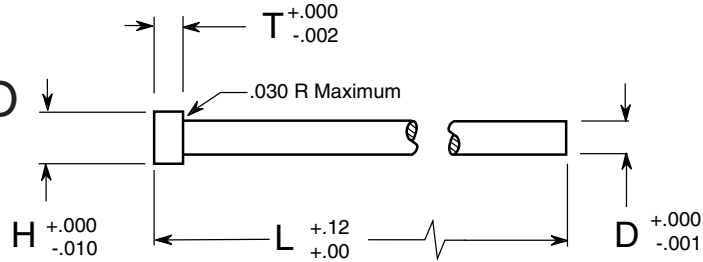

Standard Ejector Pins

Style No. NEP	D Pin Dia.	H Head Dia.	T Head Thick	Length			
				L-6"	L-10"	L-14"	L-18"
04	3/64	1/4	1/8	4.38	5.52	11.77	-
06	1/16	1/4	1/8	4.07	5.27	9.66	-
07	5/64	1/4	1/8	4.07	4.93	9.56	-
09	3/32	1/4	1/8	3.67	4.13	8.77	-
10	7/64	1/4	1/8	3.67	4.13	4.94	-
12	1/8	1/4	1/8	1.99	2.22	2.79	6.51
14	9/64	1/4	1/8	2.31	2.37	3.26	6.20
15	5/32	9/32	5/32	2.06	2.32	3.00	4.20
17	11/64	11/32	3/16	2.47	2.52	3.36	-
18	3/16	3/8	3/16	2.15	2.48	3.31	4.36
20	13/64	3/8	3/16	-	2.77	3.57	-
21	7/32	13/32	3/16	2.32	2.76	3.68	5.20
23	15/64	13/32	3/16	-	3.04	3.94	-
25	1/4	7/16	3/16	2.48	3.09	3.92	5.04
26	17/64	7/16	1/4	-	3.57	4.29	-
28	9/32	7/16	1/4	2.90	3.71	4.42	5.92
29	19/64	1/2	1/4	-	3.92	4.94	-
31	5/16	1/2	1/4	3.21	4.13	4.94	6.51
32	21/64	9/16	1/4	-	4.42	5.77	-
34	11/32	9/16	1/4	3.61	4.63	5.85	-
35	23/64	5/8	1/4	-	4.94	6.26	-
37	3/8	5/8	1/4	3.81	5.15	6.32	8.55
40	13/32	11/16	1/4	4.22	5.75	7.45	9.83
43	7/16	11/16	1/4	4.63	6.32	8.06	10.97
46	15/32	3/4	1/4	5.96	6.93	11.57	12.12
50	1/2	3/4	1/4	5.55	7.54	9.93	13.13
56	9/16	13/16	1/4	6.87	9.39	11.97	15.65
62	5/8	7/8	1/4	7.97	11.03	13.90	18.06
68	11/16	15/16	1/4	10.51	13.01	18.37	21.32
75	3/4	1"	1/4	11.13	14.95	19.05	24.40
87	7/8	1 1/8	1/4	24.42	28.72	48.83	68.99
100	1"	1 1/4	1/4	25.57	28.72	56.60	73.24

.005 Oversize Ejector Pins

Style No. NEO	D Pin Dia.	H Head Dia.	T Head Thick	Length	
				L-10"	L-14"
04	3/64	1/4	1/8	8.09	-
06	1/16	1/4	1/8	6.15	-
07	5/64	1/4	1/8	6.15	-
09	3/32	1/4	1/8	5.39	-
10	7/64	1/4	1/8	5.39	7.83
12	1/8	1/4	1/8	2.50	2.98
14	9/64	1/4	1/8	2.70	-
15	5/32	9/32	5/32	2.62	3.31
17	11/64	11/32	3/16	2.87	-
18	3/16	3/8	3/16	2.80	3.55
20	13/64	3/8	3/16	5.83	-
21	7/32	13/32	3/16	3.10	-
23	15/64	13/32	3/16	5.94	-
25	1/4	7/16	3/16	3.38	4.35
26	17/64	7/16	1/4	5.99	-
28	9/32	7/16	1/4	3.81	-
29	19/64	1/2	1/4	6.05	-
31	5/16	1/2	1/4	4.22	5.50
32	21/64	9/16	1/4	6.09	-
34	11/32	9/16	1/4	4.79	-
35	23/64	5/8	1/4	6.20	-
37	3/8	5/8	1/4	5.35	6.92
40	13/32	11/16	1/4	6.02	-
43	7/16	11/16	1/4	6.57	8.82
46	15/32	3/4	1/4	7.17	-
50	1/2	3/4	1/4	7.89	10.54

### How To Order: EXAMPLE

Style	Dia. x Lgth.	Qty.
NEP 06	1/16 x 14"	50

- When ordering specify NEP or NEO
- Specifications: H-13 hot work die steel; heads forged and annealed; body nitrided; honed finish