

CORE PINS

STYLES CP AND CPH

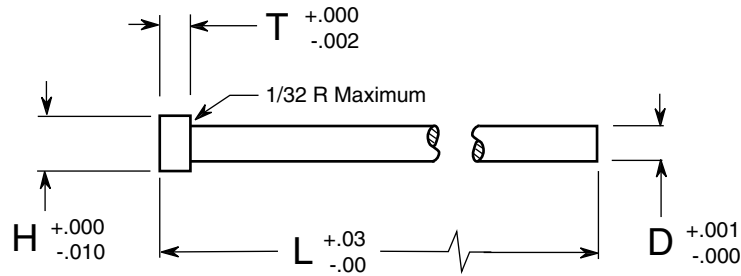

Type CP—Standard Hardness Rc 30/35

Style No. CP	D Pin Dia.	H Head Dia.	T Head Thick	Length		
				3"	6"	10"
09	3/32	1/4	1/8	4.25	4.40	5.10
10	7/64	1/4	1/8	4.40	4.55	5.40
12	1/8	1/4	1/8	2.65	2.70	3.60
14	9/64	1/4	1/8	2.65	2.75	3.60
15	5/32	9/32	5/32	2.70	2.80	3.65
17	11/64	11/32	3/16	2.70	2.80	3.80
18	3/16	3/8	3/16	2.75	2.85	3.85
20	13/64	3/8	3/16	2.80	2.95	3.90
21	7/32	13/32	3/16	2.90	3.10	4.10
25	1/4	7/16	3/16	3.10	3.25	4.35
28	9/32	7/16	1/4	3.40	3.55	4.75
31	5/16	1/2	1/4	3.80	3.90	5.25
34	11/32	9/16	1/4	4.10	4.25	5.65
37	3/8	5/8	1/4	4.55	4.75	6.25
40	13/32	11/16	1/4	4.90	5.10	6.80
43	7/16	11/16	1/4	5.45	5.60	7.45
46	15/32	3/4	1/4	5.85	6.15	8.15
50	1/2	3/4	1/4	6.40	6.65	8.75
56	9/16	13/16	1/4	—	7.80	10.40
62	5/8	7/8	1/4	—	9.30	12.20
75	3/4	1"	1/4	—	12.70	16.65

Type CPH—High Hardness Rc 50/54

Style No. CPH	D Pin Dia.	H Head Dia.	T Head Thick	Length		
				3"	6"	10"
09	3/32	1/4	1/8	4.50	4.70	5.55
10	7/64	1/4	1/8	4.60	4.75	5.75
12	1/8	1/4	1/8	2.80	2.95	3.80
14	9/64	1/4	1/8	2.80	3.05	3.80
15	5/32	9/32	5/32	3.00	3.10	3.85
17	11/64	11/32	3/16	3.00	3.10	4.05
18	3/16	3/8	3/16	3.00	3.20	4.05
20	13/64	3/8	3/16	3.05	3.25	4.20
21	7/32	13/32	3/16	3.10	3.30	4.20
25	1/4	7/16	3/16	3.35	3.55	4.55
28	9/32	7/16	1/4	3.70	3.90	5.10
31	5/16	1/2	1/4	4.10	4.25	5.65
34	11/32	9/16	1/4	4.45	4.70	6.25
37	3/8	5/8	1/4	4.90	5.15	6.85
40	13/32	11/16	1/4	5.25	5.60	7.45
43	7/16	11/16	1/4	5.85	6.15	8.20
46	15/32	3/4	1/4	6.35	6.70	9.00
50	1/2	3/4	1/4	6.85	7.25	9.70
56	9/16	13/16	1/4	—	8.50	11.35
62	5/8	7/8	1/4	—	9.95	13.45
75	3/4	1"	1/4	—	13.75	18.45

How To Order: EXAMPLE

Style	Dia. x Lgth.	Qty.
CP 09	3/32 x 6"	50