

ECONOMY EJECTOR PINS

STYLE CP-O1

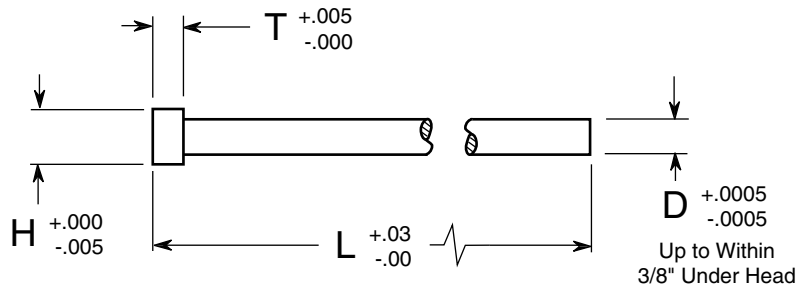

Style No. CP-O1	D	H	T	L Lengths								
	Body Dia.	Head Dia.	Head Thick	4"			6"			10"		
				100+	50-99	1-49	100+	25-99	1-24	100+	25-99	1-24
06	1/16	7/64	3/64	2.15	2.37	2.57	2.85	3.04	3.26	-	-	-
07	5/64	9/64	3/64	2.01	2.18	2.38	2.64	2.84	3.02	-	-	-
09	3/32	5/32	5/64	1.92	2.11	2.31	2.54	2.72	2.91	3.45	3.64	3.86
10	7/64	3/16	5/64	2.01	2.18	2.38	2.61	2.80	2.99	3.57	3.76	3.98
12	1/8	7/32	3/32	1.77	1.92	2.09	2.31	2.46	2.62	3.11	3.31	3.49
14	9/64	1/4	7/64	1.77	1.92	2.09	2.31	2.46	2.62	3.11	3.31	3.49
15	5/32	17/64	1/8	1.77	1.92	2.09	2.31	2.46	2.62	3.11	3.31	3.49
17	11/64	5/16	1/8	1.86	2.03	2.18	2.39	2.57	2.73	3.23	3.40	3.58
18	3/16	5/16	9/64	1.86	2.03	2.18	2.39	2.57	2.73	3.23	3.40	3.58
20	13/64	11/32	5/32	2.04	2.19	2.37	2.48	2.64	2.80	3.32	3.50	3.69
21	7/32	3/8	5/32	2.20	2.38	2.55	2.66	2.84	2.99	3.52	3.70	3.87
23	15/64	13/32	11/64	2.31	2.46	2.62	2.85	3.02	3.18	3.61	3.80	3.99
25	1/4	7/16	3/16	2.31	2.46	2.62	2.85	3.02	3.18	3.61	3.80	3.99
26	17/64	7/16	1/4	2.74	2.91	3.08	3.03	3.20	3.34	3.71	3.88	4.07
28	9/32	7/16	1/4	2.74	2.91	3.08	3.03	3.20	3.34	3.71	3.88	4.07
29	19/64	1/2	1/4	2.93	3.10	3.26	3.11	3.27	3.45	3.89	4.08	4.26
31	5/16	1/2	1/4	2.93	3.10	3.26	3.11	3.27	3.45	3.89	4.08	4.26
32	21/64	9/16	1/4	3.03	3.20	3.35	3.29	3.47	3.63	4.41	4.58	4.78
34	11/32	9/16	1/4	3.03	3.20	3.35	3.29	3.47	3.63	4.41	4.58	4.78
35	23/64	5/8	1/4	3.11	3.27	3.45	3.49	3.65	3.81	4.80	4.99	5.17
37	3/8	5/8	1/4	3.11	3.27	3.45	3.49	3.65	3.81	4.80	4.99	5.17

How To Order: EXAMPLE

Style	Dia.	Length	Qty.
CP-01 12	1/8	4."	200

- Delivery from stock
- Specifications: oil hardening tool steel; hardness Rc 58/60; heads annealed Rc 42/45