

PILOT PUNCHES

M-2: Rc 60/63 • A-2: Rc 60/62 • D-2, PM-M4, PM-10V: Rc 61/63 • See Page 16 for Prices

STYLE SPP

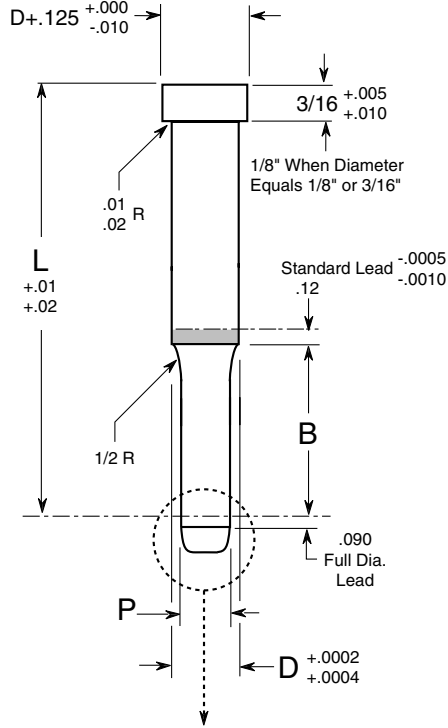

Parabolic Points at Various Diameters

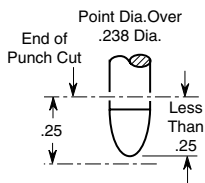
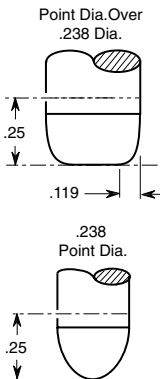

Style SPP	Body Dia. D	Standard Lengths (Does not include pilot) L												Point Length B	Point Diameter P			
		L													Min.	Max.		
12	1/8	1 1/4	1 1/2	1 3/4	2	2 1/4	2 1/2	2 3/4	3					1/2	.061	.125		
					1 1/2	1 3/4	2	2 1/4	2 1/2	2 3/4	3			3/4	.061	.125		
						1 3/4	2	2 1/4	2 1/2	2 3/4	3			1	.061	.125		
							2	2 1/4	2 1/2	2 3/4	3			1 1/4	.092	.125		
18	3/16	1 1/4	1 1/2	1 3/4	2	2 1/4	2 1/2	2 3/4	3	3 1/4	3 1/2			1/2	.061	.1875		
					1 1/2	1 3/4	2	2 1/4	2 1/2	2 3/4	3	3 1/4	3 1/2	3/4	.061	.1875		
						1 3/4	2	2 1/4	2 1/2	2 3/4	3	3 1/4	3 1/2	1	.061	.1875		
							2	2 1/4	2 1/2	2 3/4	3	3 1/4	3 1/2	1 1/4	.092	.1875		
						2 1/4	2 1/2	2 3/4	3	3 1/4	3 1/2	1 1/2	.124	.1875				
25	1/4	1 1/4	1 1/2	1 3/4	2	2 1/4	2 1/2	2 3/4	3	3 1/4	3 1/2			1/2	.061	.250		
					1 1/2	1 3/4	2	2 1/4	2 1/2	2 3/4	3	3 1/4	3 1/2	3/4	.061	.250		
						1 3/4	2	2 1/4	2 1/2	2 3/4	3	3 1/4	3 1/2	1	.061	.250		
							2	2 1/4	2 1/2	2 3/4	3	3 1/4	3 1/2	1 1/4	.092	.250		
						2 1/4	2 1/2	2 3/4	3	3 1/4	3 1/2	1 1/2	.124	.250				
31	5/16	1 1/4	1 1/2	1 3/4	2	2 1/4	2 1/2	2 3/4	3	3 1/4	3 1/2	3 3/4	4	1/2	.092	.3125		
					1 1/2	1 3/4	2	2 1/4	2 1/2	2 3/4	3	3 1/4	3 1/2	3 3/4	4	3/4	.092	.3125
						1 3/4	2	2 1/4	2 1/2	2 3/4	3	3 1/4	3 1/2	3 3/4	4	1	.092	.3125
							2	2 1/4	2 1/2	2 3/4	3	3 1/4	3 1/2	3 3/4	4	1 1/4	.092	.3125
						2 1/4	2 1/2	2 3/4	3	3 1/4	3 1/2	3 3/4	4	1 1/2	.124	.3125		
37	3/8	1 1/4	1 1/2	1 3/4	2	2 1/4	2 1/2	2 3/4	3	3 1/4	3 1/2	3 3/4	4	1/2	.124	.375		
					1 1/2	1 3/4	2	2 1/4	2 1/2	2 3/4	3	3 1/4	3 1/2	3 3/4	4	3/4	.124	.375
						1 3/4	2	2 1/4	2 1/2	2 3/4	3	3 1/4	3 1/2	3 3/4	4	1	.124	.375
							2	2 1/4	2 1/2	2 3/4	3	3 1/4	3 1/2	3 3/4	4	1 1/4	.124	.375
						2 1/4	2 1/2	2 3/4	3	3 1/4	3 1/2	3 3/4	4	1 1/2	.124	.375		
43	7/16	1 1/2	1 3/4		2	2 1/4	2 1/2	2 3/4	3	3 1/4	3 1/2	3 3/4	4	3/4	.186	.4375		
			1 3/4		2	2 1/4	2 1/2	2 3/4	3	3 1/4	3 1/2	3 3/4	4	1	.186	.4375		
					2	2 1/4	2 1/2	2 3/4	3	3 1/4	3 1/2	3 3/4	4	1 1/4	.186	.4375		
						2 1/4	2 1/2	2 3/4	3	3 1/4	3 1/2	3 3/4	4	1 1/2	.186	.4375		
50	1/2	1 1/2	1 3/4		2	2 1/4	2 1/2	2 3/4	3	3 1/4	3 1/2	3 3/4	4	3/4	.224	.500		
			1 3/4		2	2 1/4	2 1/2	2 3/4	3	3 1/4	3 1/2	3 3/4	4	1	.224	.500		
					2	2 1/4	2 1/2	2 3/4	3	3 1/4	3 1/2	3 3/4	4	1 1/4	.224	.500		
						2 1/4	2 1/2	2 3/4	3	3 1/4	3 1/2	3 3/4	4	1 1/2	.224	.500		
62	5/8	1 1/2	1 3/4		2	2 1/4	2 1/2	2 3/4	3	3 1/4	3 1/2	3 3/4	4	3/4	.309	.625		
			1 3/4		2	2 1/4	2 1/2	2 3/4	3	3 1/4	3 1/2	3 3/4	4	1	.309	.625		
					2	2 1/4	2 1/2	2 3/4	3	3 1/4	3 1/2	3 3/4	4	1 1/4	.309	.625		
						2 1/4	2 1/2	2 3/4	3	3 1/4	3 1/2	3 3/4	4	1 1/2	.309	.625		
75	3/4	1 1/2	1 3/4		2	2 1/4	2 1/2	2 3/4	3	3 1/4	3 1/2	3 3/4	4	3/4	.389	.750		
			1 3/4		2	2 1/4	2 1/2	2 3/4	3	3 1/4	3 1/2	3 3/4	4	1	.389	.750		
					2	2 1/4	2 1/2	2 3/4	3	3 1/4	3 1/2	3 3/4	4	1 1/4	.389	.750		
						2 1/4	2 1/2	2 3/4	3	3 1/4	3 1/2	3 3/4	4	1 1/2	.389	.750		
100	1	1 1/2	1 3/4		2	2 1/4	2 1/2	2 3/4	3	3 1/4	3 1/2	3 3/4	4	3/4	.484	1.000		
			1 3/4		2	2 1/4	2 1/2	2 3/4	3	3 1/4	3 1/2	3 3/4	4	1	.484	1.000		
					2	2 1/4	2 1/2	2 3/4	3	3 1/4	3 1/2	3 3/4	4	1 1/4	.484	1.000		
						2 1/4	2 1/2	2 3/4	3	3 1/4	3 1/2	3 3/4	4	1 1/2	.484	1.000		

How To Order: EXAMPLE

Style	Length	Mat.	Pt. Dia.	Pt. Lgth.	Tol.	Qty.
SPP 50	3 3/4"	M-2	.2718	1 1/2"	#2	19

Tolerance	Concentricity	
	P to D	T.I.R.
#1 +.0002 -.0	.0003	
#2 +.0005 -.0	.0005	